

User's manual

MD-S100

SMART DOOR LOCK



WWW.METANETWORKS.CO.KR

* The content of this manual is subject to change without prior notice in order to enhance the performance of the product.

- Firm and solid carefree : KC approved, quality control system
- Durable metal body
- Auto locking/Re-locking/Double locking
- Multiple registrations of passwords/Key Tags: Up to 4 passwords/ Up to 30 Key Tags
- No concern about the password being accidentally exposed: Open door with false passwords
- 8 level volume adjusting function/temporary mute function
- 9V Battery emergency power source
- Anti-shock(ESD prevention)/Anti-fire/Anti-hacking system

Safety Caution

1 Do not disassemble, reassemble or repair the product by yourself.

1 Do not install the product in outdoor environment.

1 Read this manual carefully before use.

1 Do not use sharp objects like a drill, pin, and screw driver to press buttons.

1 Change your password regularly.

1 Do not use excessive force.

1 Improperly installed batteries can cause rupture or battery fluid leakage.

1 Keep the product away from water or any liquids.

1 Replace all batteries immediately after they run out of power, and do not mix old with new batteries.

1 Clean only with a dry cloth.

1 Do not use the product for other use.

Identification

1. Outer body

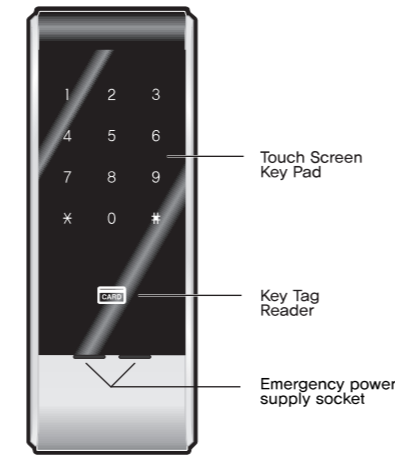

2. Inner body

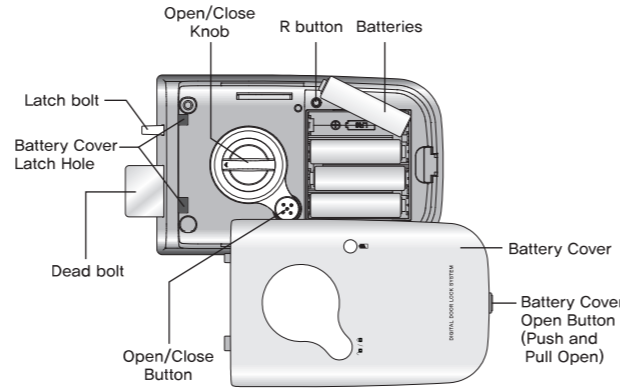

Product Specifications and Component overview

1. Product specifications

Description	Specification
Door thickness	35mm~55mm
Password	4~12 digits (up to 4 password)
Key Tag	Up to 30 Key Tags
Power	DC6V (4 LR6 1.5V AA Alkaline battery)
Emergency Power	DC9V Alkaline Battery (not included)
Fire Detection temperature	60°C ± 10°C
Outer body material	Al, ABS
Inner body material	Al, ABS

2. Component overview

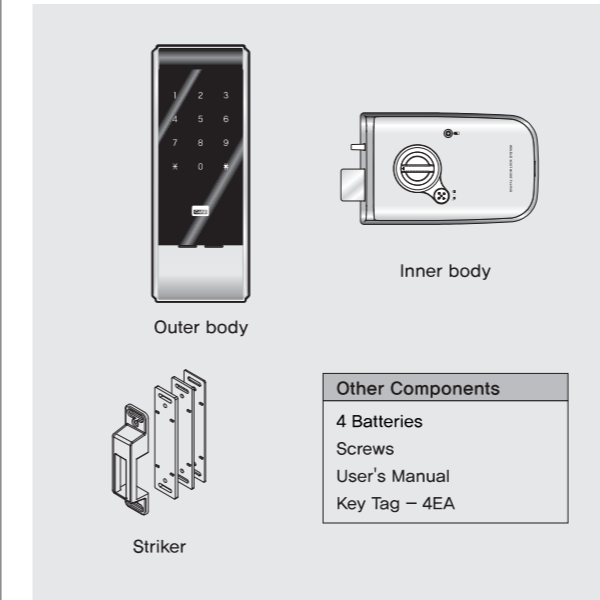

Register and change a password

Caution Make sure to leave the door open during the registration process.

1 **[Inside]** Open the battery cover, press [R] button shortly and alarm will sound.

2 **[Outside]** Enter the new password with button when the key pad is illuminated. (4 to 12 digits)

3 **[Outside]** Press [R] button and alarm will sound.

4 **[Outside]** Press [R] button one more time then the key pad will turn off.

Note The default password is 1234. To register more than one password (up to 4), repeat 2 and 3 step above before the outer body's key pad is off. To prevent the password exposure, enter any fake password before entering the registered password. (Touch the key pad or press [R] button + fake password + registered password.)

Caution If no more input is made after pressing [R] button for 7 seconds, the whole process is canceled. When registering a new password, the old password will be deleted automatically. Password must not contain consecutive numbers. (For example: 3456 or 567890)

Register Key Tags

Caution Register all available Key Tags at the same time.

1 **[Inside]** Open the battery cover, press [R] button shortly and alarm will sound.

2 **[Outside]** Place the card to be registered to the card reader. (Alarm will sound every time place the card.)

3 **[Outside]** After registering all key tags, press [R] button to finish registering process.

Note To register more than one key tag (up to 30), make sure to repeat the above 2 before the key pad is turned off.

Caution If no more input is made after pressing [R] button, the whole registration process is canceled. After registering new key tags, the old key tags will be unregistered automatically.

Delete All Registered Key Tags

1 **[Inside]** Open the battery cover, press [R] button shortly and alarm will sound.

2 **[Outside]** Press [R] for 5 seconds until alarm sounds. Then all card information will be deleted.

Opening a door from outside

1 **[Open a door with password]** Touch the key pad, enter the password with [R] button, [Password] or [fake password] + [password] + [R] Then the door will open with the alarm.

2 **[Open a door with Key Tag]** Place a registered key tag on the key tag reader. Then the door will open with the alarm.

Locking a door from outside

1 **[In the Automatic Locking Mode]** The door is automatically locked after the door is closed.

2 **[In the Manual Locking Mode]** The door is locked when the key pad is touched.

Opening a door from inside

1 **[Open a door with Open/Close Button]** Press open/close button.

2 **[Open a door manual]** Turn the [Open/Close] knob.

Caution In the automatic lock mode, if the door is not open for 7 seconds after unlocked the door, the door will be locked automatically.

Locking a door from inside

1 **[Lock a door with Open/Close Button]** Press open/close button.

2 **[Lock a door manual]** Turn the [Open/Close] knob.

Double Locking

Outside Double Locking

How to Set

1 Touch the key pad.

2 Enter the registered password.

3 Press [R] button, then keep [R] button until alarm sounds 3 times.

How to Deactivate
Open the door with password, or key tag.

Inside Double Locking

How to Set
Press the [Open/Close] button for 3 seconds from the inside while the door is locked.

How to Deactivate
Turn open/close knob or press open/close button, then open the door.

Volume Adjusting Function

1 Touch the key pad.

2 Enter the registered password.

3 Press [R] button.

4 Press [R] button to increase volume or [R] button to decrease volume.

Note In the temporary mute mode, every time enter the number the key pad will illuminate.

Automatic/Manual Locking

Automatic Locking

Make sure to leave the door open.

1 Set the deadbolt in close position.

2 Touch the key pad.

3 Enter the registered password.

4 Press [R] button twice.

5 Press [R] button, then the confirmation alarm will sound.

Manual Locking

Make sure to leave the door open.

1 Set the deadbolt in close position.

2 Touch the key pad.

3 Enter the registered password.

4 Press [R] button twice.

5 Press [R] button, then the confirmation alarm will sound.

Caution In the manual locking mode, touch the key pad for 2 seconds or so, the door will lock.

Fire Detection Function

When the sensor detects high temperature (60°C ± 10°C), the door will unlock automatically with a loud alarm sound.

Caution If the main body is exposed to direct heat for a long time, the fire detection function can be activated.

To disable fire detection alarm, remove battery or enter the registered password or place the key tag to the key tag reader. (When the body temperature is high, this function cannot be disabled.)

Trespassing/Damage Alarm

An alarm (louder than 80DB) will activate if someone tries break-in by opening the door when it was locked or by damaging the door lock due to forced separation or drilling.

To deactivate trespassing / damage alarm, remove battery or in the registered password or place the key tag to the key tag reader.

1 Minute Lock Mode

If unregistered passwords enter or unregistered key tags place to the key tag reader for 5 times consecutively, 1 minute lock mode will activate and the system will suspend during 1 minute.

Deadbolt miss-location Warning Sound

"beep-beep-beep-beep-beep"^{x3} alarm will sound 3 times when the deadbolt is not working properly.

Caution If the warning sound continues, it requires to reinstall or adjust the position of the door lock.

Battery Exchange Warning Sound

When red LED flashes on the key pad with the warning sound, replace all 4 batteries immediately.

Note When the lock fails to operate due to completely discharged batteries, follow the steps below.

1 Purchase 9V battery.

2 Contact the 9V battery to the emergency power supply socket.

3 While contacting the battery, press [R] button to activate numeric keypad.

4 Keep contacting the battery, enter the registered password.

5 Press [R] button again, the door will be locked with the confirmation whistle sound.

Caution Do not mix old with new batteries or use different types.

Trouble Shooting

*When the product is not working properly, check the item below. If you can't solve the problem, please contact service center for further assistance.

Problem	Troubleshooting
There is no power	<ul style="list-style-type: none"> • Check to make sure the batteries are in a good condition, with the poles (±) placed correctly. • Check to see if the battery is completely discharged, or have been inserted improperly.
The password cannot be changed (5 page)	<ul style="list-style-type: none"> • Press [R] button shortly until alarm sounds. • See page 5 and try again.
The door cannot be opened with password (5 page)	<ul style="list-style-type: none"> • Check that the registered password has been correctly entered. • The key pad will turn off in 7 seconds automatically if password is not being entered. • If the key pad is not illuminated while password is being entered, the entry will not be accepted. Reenter the password from the beginning when the key pad is illuminated after pressing [R] button.
The door cannot be opened with password or key tag (11 page)	<ul style="list-style-type: none"> • Check if battery is flat or completely dead. In that case, use 9V emergency battery. • If it still does not operate, contact service center.
It is working properly but making a warning sound (11 page)	<ul style="list-style-type: none"> • When the battery is flat, it generates a battery exchange warning sound. Replace all 4 batteries.
The door does not lock automatically (9 page)	<ul style="list-style-type: none"> • Set automatic locking mode • Check to see if battery is flat. In that case replace all 4 batteries.

Product Certification

Device Name	Wireless Device for RFID/USN
Certified Party	META NETWORKS.CO.,LTD
Manufacturer / Country	META NETWORKS.CO.,LTD / KOREA
Certified Number	MSIP-CMM-MNL-MD-S100
Date of manufacture	

- * The product is compliance with Electromagnetic Regulations for home (Level B).
- * The content of this manual is subject to change without prior notice in order to enhance the performance of the product.